



### 6" Cladding / Soffit Panel KEC150 (Stock Item)

#### SPECIFICATIONS

Imperial Size:	6" x 5/8" x 18'6"
Metric Size:	150mm x 16mm x 5650mm
Material Thickness:	1.4mm
Uses:	Cladding, Soffit
Weight per Piece:	12.22 LBS / 5.54 KG
Weight / Sq. Foot:	1.32 LBS / 0.6 KG
Coverage / piece:	9.25 Sq. Feet / 0.85 Sq. Meters
Case Coverage:	462.5 Sq. Feet / 42.9 Sq. Meters
Case Quantity:	50 Pieces

#### FEATURES

- Interlocking Assembly
- Top down or Bottom up installation
- Horizontal, Vertical, Diagonal
- 0 to 1/4" Reveal between Panels
- Fastening 32" on center or less
- Quick install Cladding Clips
- 30+ Woodgrain Colors
- 70+ Solid and Custom Colors

1/16"  
1.4 mm

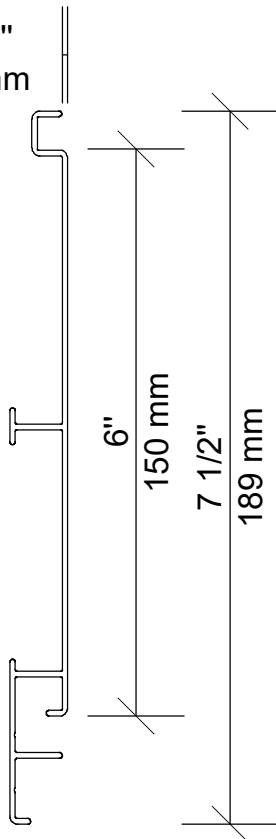

KEC150  
6" CLADDING

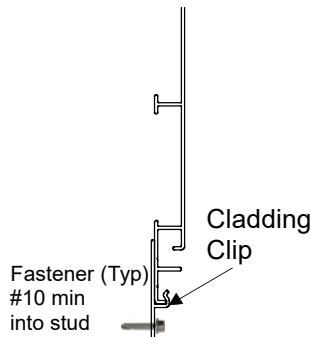

Allows for expansion and contraction and simplifies installation.

CLADDING CLIP

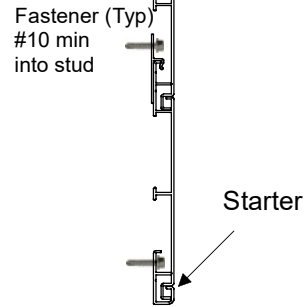

BOTTOM UP  
INSTALLATION

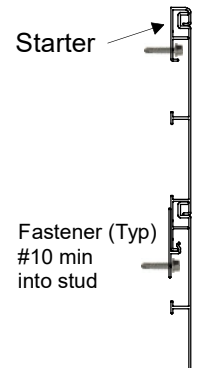

Allows for quicker install and easy replacement of ground level damage.

TOP DOWN  
INSTALLATION

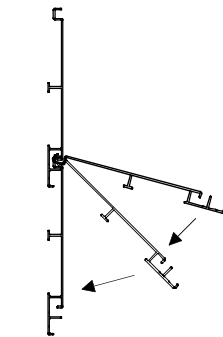

Creates interlocked assembly, eliminates failures and eases installation.

INTERLOCKING  
ASSEMBLY

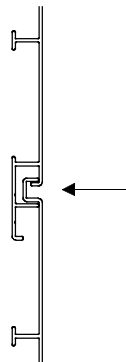

Allows for adjustable spacing from 0 to 1/4".

1/4" SPACING

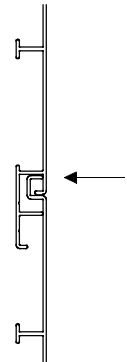

Creates sleek, flat appearance.

NO SPACING

# KNOTWOOD™ CLADDING SYSTEM

## 6" CLADDING (KEC150) BOTTOM UP ASSEMBLIES

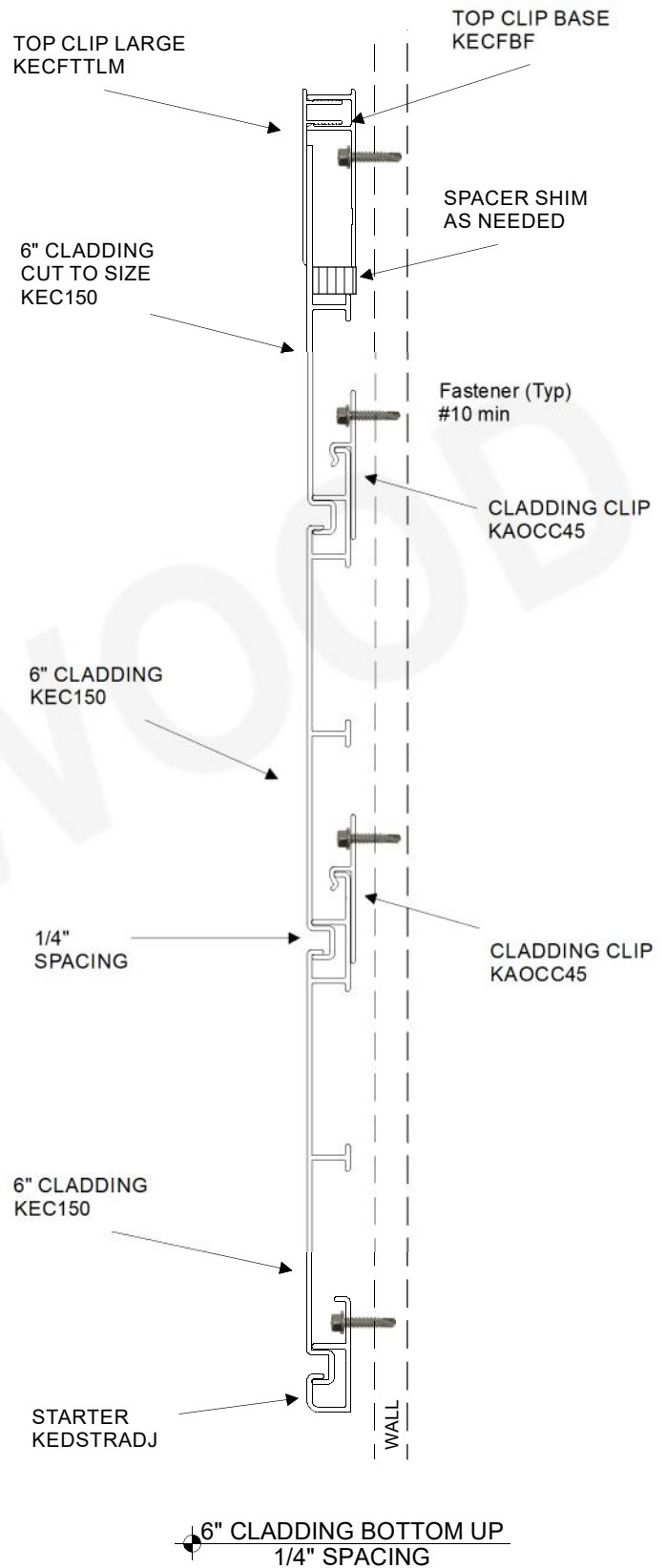
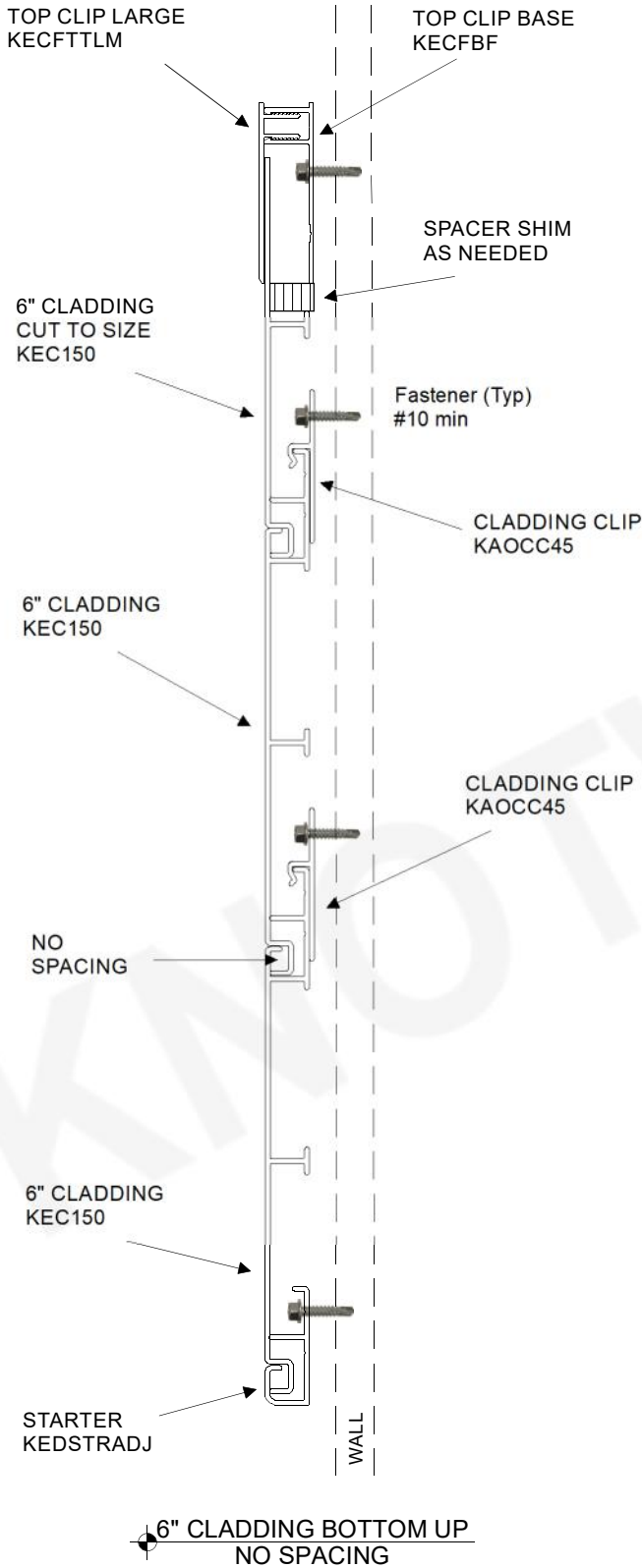

# KNOTWOOD™ CLADDING SYSTEM

## 6" CLADDING (KEC150) TOP DOWN ASSEMBLIES

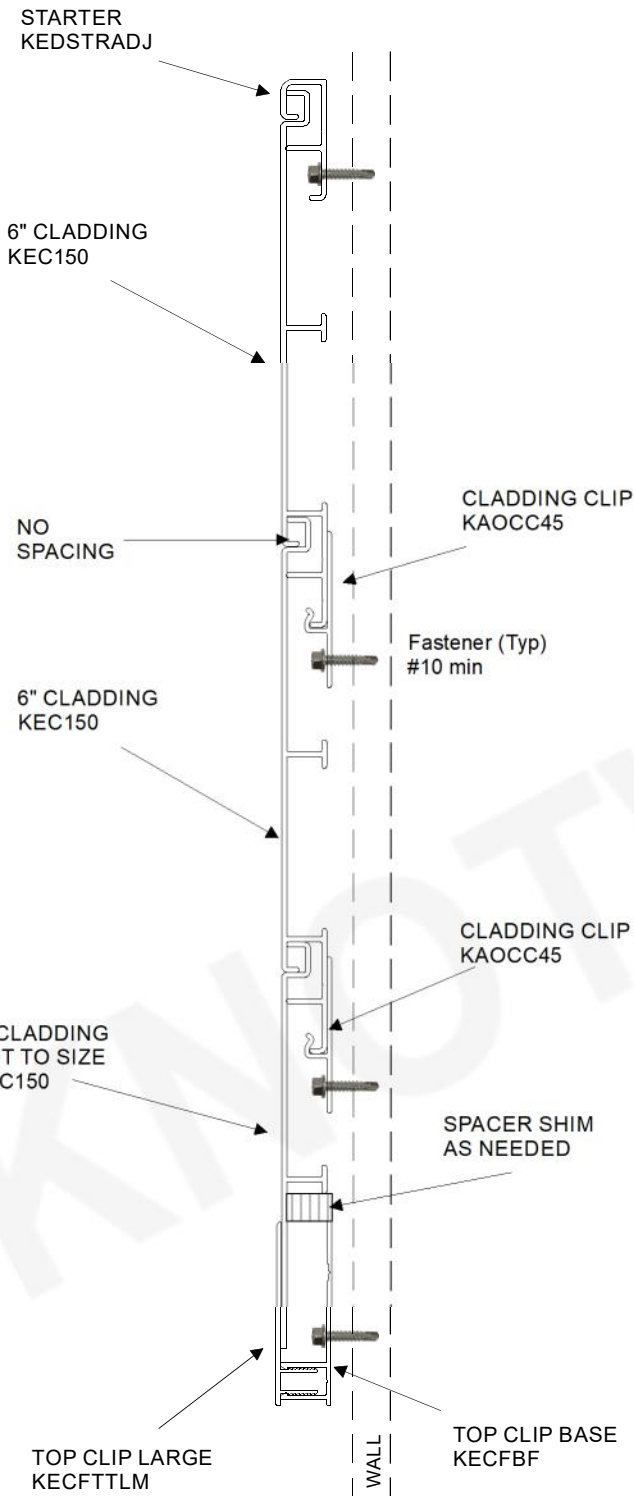

6" CLADDING TOP DOWN  
NO SPACING

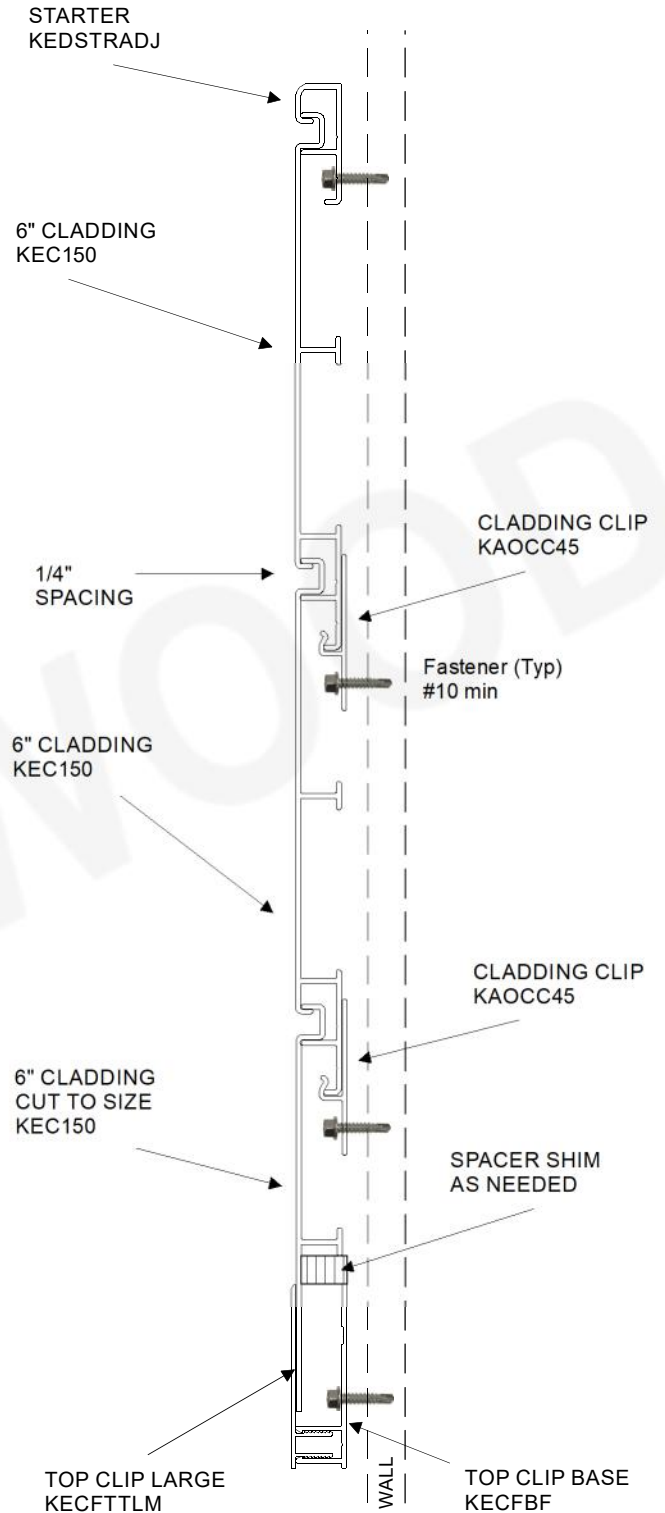

6" CLADDING TOP DOWN  
1/4" SPACING